

ARIETE NS8315Energy

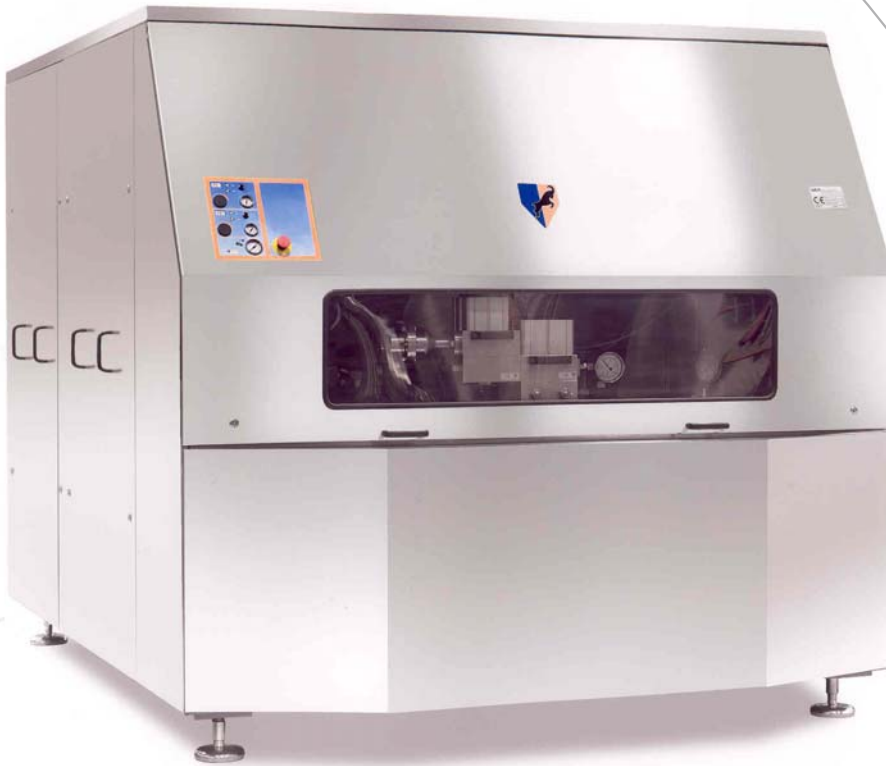

The Ariete Energy Series high pressure homogeniser/pump features the latest in design concept, contributing to excellence in performance and reliability.

Liquid end

- High quality stainless steel and special high wear resistance materials for best mechanical and corrosion resistance performances
- 3A and electropolished versions available
- Ball (PVB) and poppet valves (PVP) interchangeable into the same block design for maximum product handling flexibility
- Aseptic version compression block available with sterile condensate packing flushing
- Various materials for pumping plungers

Homogenising valve

- One stage (standard on homogenizers) with pneumatic adjustment from the machine's control panel
- High efficiency design valve NanoValve[®], based on advanced fluid dynamics concepts, available as option
- Engineered for easy maintenance and cleaning
- Second stage option

Power end

- Heavy duty and reliable power frame
- AC motor drive
- Forced lubrication with gear pump and low oil pressure switch
- "V" belts drive train and high performances tooth-belt transmission

Casing

- Made in polished stainless steel with sound proof lining
- Easy access and maintenance with removable panels
- Noise reduction execution (≤ 75 dB) available

Tools and spares parts

- Special tools and one set of emergency spares parts supplied with the machine
- Two copies of detailed O&M manual

- Designed according to the EU safety rules (CE standards), engineered, manufactured and tested according to ISO EN 9001 Quality System
- Sanitary and aseptic execution, designed for CIP and SIP
- Suitable for abrasive and viscous products
- Homogenizing pressure up to 700 bar
- Monoblock compression head design up to 700 bar pressure
- Easy implementation in remote control systems and complete process lines

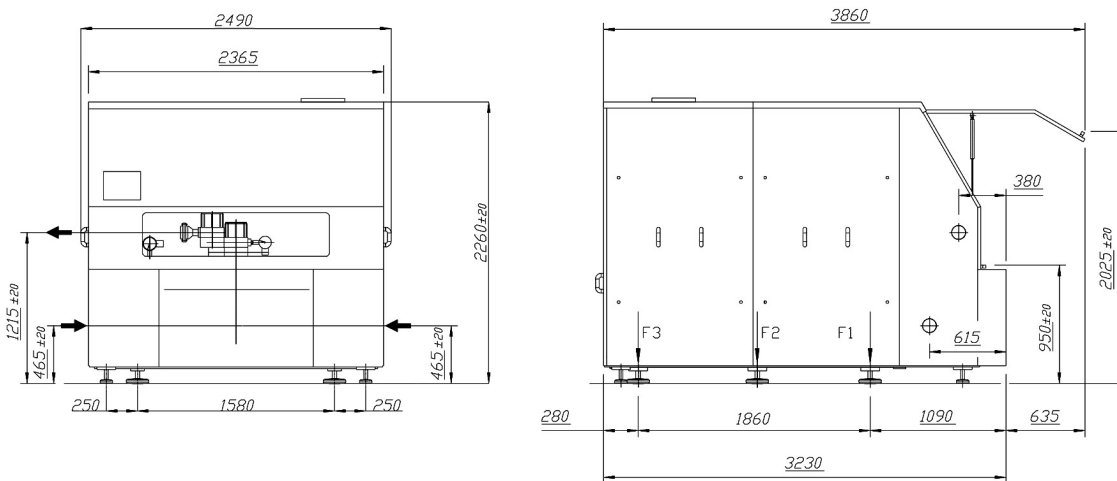

*measure in mm

Performances

	100 bar	150 bar	200 bar	250 bar	400 bar	600 bar	700 bar	1000 bar	1200 bar
Max Flow Rate (l/h)	50000	50000	45000	36000	21000	14500	11500	—	—

Design Features and Materials

- Compression head — special high grade duplex / super-duplex SS alloy
- MONOBLOCK construction
- Pump Valves — high wear resistant Stellite® alloy removable seats
- ball type (PVB) or poppet type (PVP) in solid Stellite®
- Pistons — Chrome coated stainless steel
- Tungsten carbide coated stainless steel
- Solid ceramic
- Homogenizing Valve — Pneumatic actuated
- wear parts made of Tungsten Carbide, Ceramics as option
- high efficiency NanoValve® available as option
- Product line connections — DIN 11851, Tri-Clamp®
- others as option upon request
- Power end — rugged cast iron power frame
- forced lubrication with low oil pressure switch
- totally enclosed sound proof execution with removable SS panels
- Main options — high pressure pump version
- 2nd stage homogenizing valve
- electric power board for fixed or variable capacity

Technical Data

Number of plungers	8
Stroke.....	100 mm
Absorbed motor power up to.....	315 kW
Weight	12000 kg
Water consumption.....	320 lph
Lubricating oil ISO VG 150.....	150 l